



OSM 60-156P Series

250-270W Polycrystalline Module



High efficiency, all the innovative manufacturing technology, brings high conversion efficiency (up to 16.49%)



Outstanding performance in weak-light conditions



Certified to withstand increased loads of up to 5400Pa



Excellent temperature coefficient giving higher yields in the long term



Anti-PID

Management System and Product Certificate

Conform to IEC 61215, IEC 61730, CEC Listed and CE

ISO 9001: 2015: ISO Quality Management System

ISO 14001: 2015: ISO Environmental management system



Linear Performance Warranty

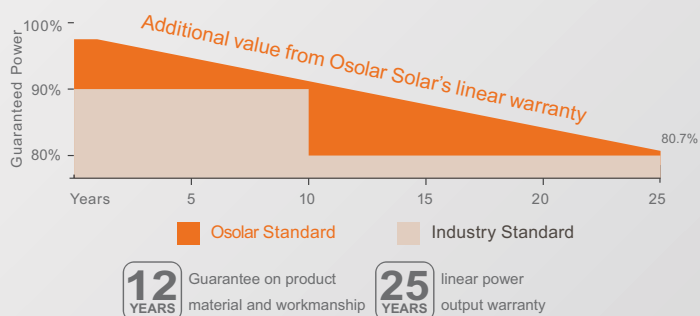

DATA (STC)

ELECTRICAL DATA(STC)

Peak Power Watts-P _{MAX} (Wp)	250	255	260	265	270
Power Output Tolerance-P _{MAX} (W)	0 ~ +5W				
Maximum Power Voltage-V _{MPP} (V)	31.70	31.90	32.10	32.40	32.70
Maximum Power Current-I _{MPP} (A)	7.92	8.00	8.10	8.18	8.28
Open Circuit Voltage-V _{OC} (V)	38.00	38.10	38.20	38.30	38.40
Short Circuit Current-I _{SC} (A)	8.55	8.60	8.67	8.73	8.82
Module Efficiency η_m (%)	15.3	15.6	15.9	16.2	16.5

STC:Irradiance 1000 W/m², Cell Temperature 25 °C, Air Mass AM1.5.

MECHANICAL DATA

Solar cells	Polycrystalline 156 × 156 mm (6 × 6 inches)
Cell orientation	60 cells (6 × 10)
Module dimensions	1650 × 992 × 40 mm (65.0 × 39.1 × 1.6 inches)
Weight	18.6 kg (41 lb)
Glass	3.2 mm (0.13 inches), High Transmission, AR Coated Tempered Glass
Frame	Silver & black anodized aluminium alloy
Backsheet	Silver & black
J-Box	IP67 rated (3 diodes)
Cables	Photovoltaic Technology cable 4.0mm ² (0.006 inches ²), 900mm (35.46 inches)
Connector	MC4 or MC4 Compatible

TEMPERATURE RATINGS

Nominal Operating Cell Temperature (NOCT)	44 °C (±2 °C)
Temperature Coefficient of P _{MAX}	- 0.39%/°C
Temperature Coefficient of V _{OC}	- 0.29%/°C
Temperature Coefficient of I _{SC}	0.05%/°C

PACKAGING

Standard packaging	26pcs/pallet
Module quantity per 20' container	312 pcs
Module quantity per 40' container	728 pcs

MAXIMUM RATINGS

Operational Temperature	-40~+85 °C
Maximum System Voltage	1000V DC(IEC)
Max Series Fuse Rating	15A

Module Diagram

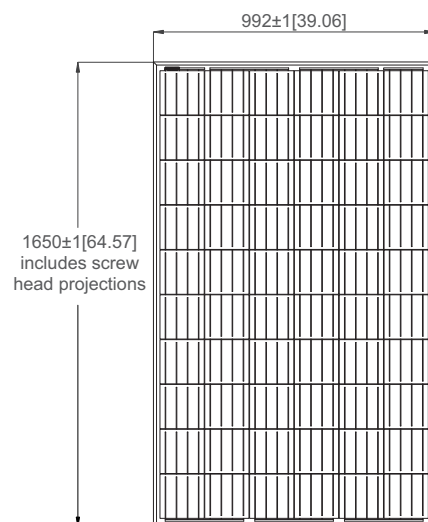

Dimensions in brackets are in inches.
Un-bracketed dimensions are in millimeters.
Unit: mm[in.]

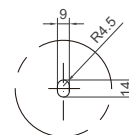
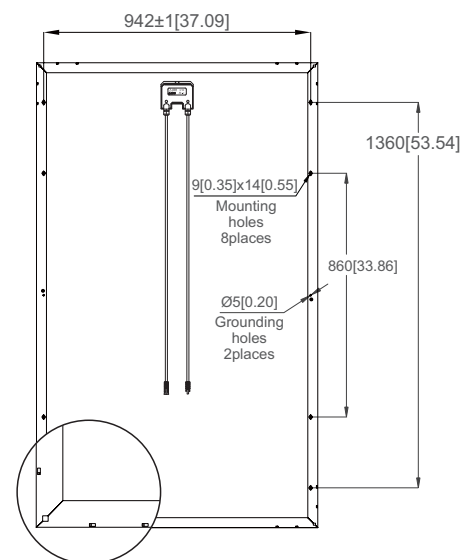

I

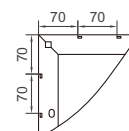

II

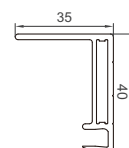

Section A- A

I-V & P-V Curves

SOLAR MODULE 60-260W

